

Recommended P.C.B Layout(Top Side)

Dimension "C"
38.74
40.15

NOTES:
 Current Rating: 0.5A AC,DC
 Temperature Range: -20°C~+60°C
 Contact Resistance: 40mΩ max
 Insulation Resistance: 1000MΩ min
 Withstanding Voltage: 500V AC/minute
 Material: LCP UL 94V-0

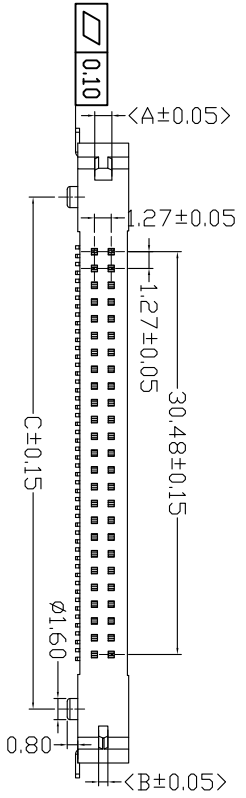

料号	品名	DIM.A	DIM.B
CF-BS-26.9	CF CARD 板上臂长26.9	1.35	0.70
CF-BX-26.9	CF CARD 板下臂长26.9	0.70	1.35

X± 0.3	X²± 5°
X± 0.25	X²± 2°
XX± 0.20	XX²± 1°
XXX± 0.10	XXX²± 0.5°

UNITS	mm
MATL	
FINISH	
QTY	PCS
DR:	HU 2016.09.28
mstconn 深圳市德瑞电子有限公司 SHENZHEN DERUI ELECTRONIC CO., LTD.	
PART NO.(INTENDED USE)	CF-BS/X-26.9
APPD:	
CHKD:	
TITLE:	CF CARD 板上/下臂长26.9
DWG NO.:	CF-BS/X-26.9
SCALE	1/1
SHEET	1/1
REV.	A