

# PITCH 1.25mm BAR CONNECTORS

性能:

- 额定电流: 1A
- 额定电压: 100V
- 耐电压: 500V
- 接触电阻:  $\leq 20m\Omega$
- 绝缘电阻:  $500M\Omega$
- 工作温度:  $-20^{\circ}C \sim +85^{\circ}C$
- 塑件 (材质): LCP, UL94V-0
- 插簧 (材质): 磷青铜, 镀锡/镀金
- 焊片 (材质): 磷青铜, 镀锡/镀金

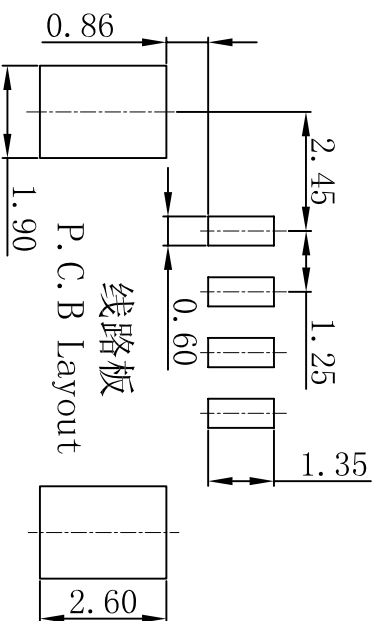
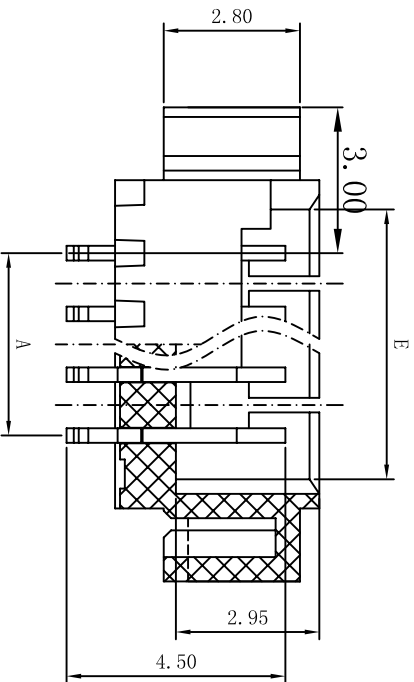
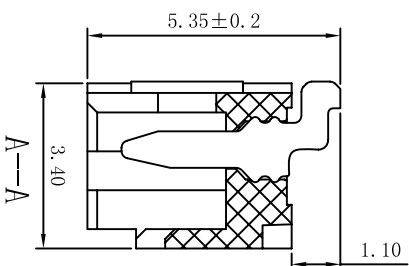
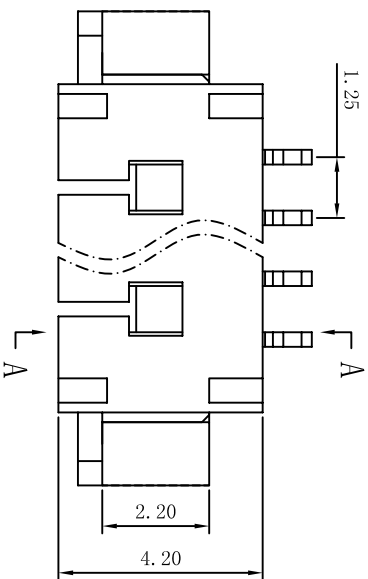
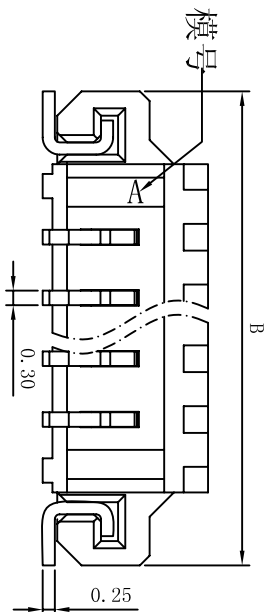

孔位	A	B	E
2	1.25	7.25	3.05
3	2.50	8.50	4.30
4	3.75	9.75	5.55
5	5.00	11.00	6.80
6	6.25	12.25	8.05
7	7.50	13.50	9.30
8	8.75	14.75	10.55
9	10.00	16.00	11.80
10	11.25	17.25	13.05
11	12.50	18.50	14.30
12	13.75	19.75	15.55
13	15.00	21.00	16.80
14	16.25	22.25	18.05
15	17.50	23.50	19.30
16	18.75	24.75	20.55

X ± 0.3	X° ± 5°	UNITS	mm
.X ± 0.25	.X° ± 2°	MAT'L	
.XX ± 0.20	.XX° ± 1°	FINISH	
.XXX ± 0.10	.XXX° ± 0.5°	Q'TY	

THESE DRAWINGS AND SPECIFICATIONS ARE THE PROPERTY OF DE RUI ELECTRONIC FACTORY AND SHALL NOT BE REPRODUCED, COPIED OR USED IN ANY MANNER WITHOUT THE PRIOR WRITTEN CONSENT OF DE RUI ELECTRONIC FACTORY

NAME (INTENDED USED)	1.25mm (D型) 条形连接器贴片式	MSTCONN	SHEN ZHEN DE RUI ELECTRONIC CO., LTD
PART NO. (INTENDED USED)	1.25-D-1P16B		
APDR:		DWG NO.:	125N06-DWB00000000
CHKD:		SCALE	1/1
DR:	YLZ 2011.09.28	SHEET	1/1
		REV.	A